



Drug testing solutions

DrugWipe is the leading choice for law enforcement, border control, rehabilitation clinics and prison systems worldwide.

Road safety and drug driving

Suspicious of drug abuse can be quickly and reliably established at roadside checks.

Rapid drug test

Easy, quick and hygienic handling. One of the best drug tests in the world with lowest sampling volume and easy to read color indicator.

DrugWipe® S

Saliva Drug Screener

ALCOLOCK is the exclusive distributor of DrugWipe in the USA



ALCOLOCK USA

10952 Santa Monica Boulevard
Los Angeles, CA 90025

1 866 700 9300

alcolockusa.com
drugwipeusa.com

Manufactured by

Securetec Detektions-Systeme AG

ALCOLOCK and the "Molly" are trademarks of Alcohol Countermeasure Systems (International) Inc. and are used under license. DrugWipe is a trademark of Securetec Detektions-Systeme AG and used under licence.



20170309



Reliable, hygienic drug detection in only 8 minutes



Saliva drug test

DrugWipe S is a robust test developed for roadside testing. The test cassette is designed for a safe transport and hygienic handling.

How does it work?

The test starts as soon as you break the integrated glass and release the liquid. The liquid helps the drug particles that are bound to the antibodies on the test strip migrate to the test line. A sequence of red lines appear on the read out window, depending on the results.

What drugs do they detect?

	5S	6S 602 G	6S 603 G
Cannabis	x	x	x
Amphetamines	x	x	x
Methamphetamines	x	x	x
Cocaine	x	x	x
Opiates	x	x	x
Ketamine		x	
Benzodiazepines			x

DrugWipe S advantages

- Test is quick and easy to administer
- Analysis and results in 3 to 8 minutes
- Certainty in detection of consumption

DrugWipe S provides accurate results with distinctive red test lines that appear even for slight traces of drugs. High specificity and reliability (over 95%) as confirmed by laboratory studies.

Quality control

The DrugWipe S contains a quality control line (CL) that authenticates functionality, all control lines must turn red after the test to ensure validity.

DrugRead® electronic test reader



The DrugRead hand held device provides user-friendly interpretation of DrugWipe S saliva tests. Perfect for use at roadside checkpoints or police stations, the DrugRead offers precise time keeping, analyzes and documents the results of DrugWipe S drug tests for later use.

Test instructions

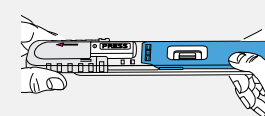
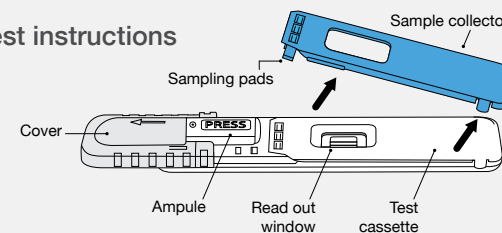

1 Slide the cover in the direction of the arrow until the word PRESS is entirely visible.

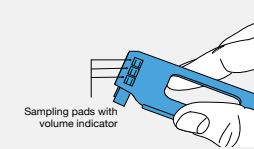

2 **Without touching the sampling pads,** remove the blue sample collector from the white test cassette.

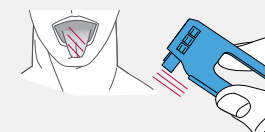

3 Ask the subject to circle the inside of their mouth with their tongue 3 times. Then use the sample collector to wipe saliva from the tongue or the inside of the cheek.

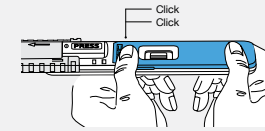

4 Snap the sample collector back onto the test cassette, **a click sound will be audible.**

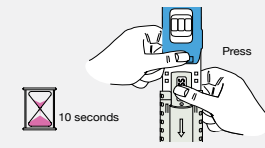

5 Hold the test cassette vertically, with the ampoule at the bottom (arrow pointing down). With your thumb, press hard on the word PRESS until the ampoule breaks. **Continue to hold for 10 seconds.**

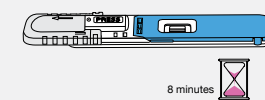

6 Put the test cassette on a leveled surface, leave undisturbed for 8 minutes, then read the results.